



FOR INDUSTRY PROFESSIONALS

Featuring
70°C (158°F) High Temp Models



HIGH TEMP/HIGH AMP CONDENSER FAN MOTORS

FEATURING



RUGGED BALL BEARING

Rugged Ball bearing design capable of handling high ambient conditions and excessive radial and axial loading.

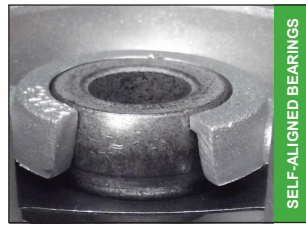

SELF-ALIGNED BEARINGS

Revolutionary self-aligned bearing system which requires no further lubrication and is capable of all angle mounting. It is NOT a babbit style sleeve bearing.



MULTI-HP CONDENSER

Multi-Horsepower motors are single speed with 2 leads designed to run at a range of load points that correspond to the rated horsepowers. They're easier to install than a 3 lead motor.



CONDENSER MOTOR

Extended mounting bolts on lead end of motor. For shaft up application, simply reverse the direction of the bolts. Condenser models include Rheem† side shell holes.

(HT) High Temperature Models Feature 70°C (158°F) Ambient Temperature Ratings

Designed specifically for regions subject to high temperatures. Providing superior performance and reliability in high ambient conditions compared to most OEM (40° C) or standard aftermarket (60° C) replacement motors. A premium replacement condenser fan motor you can trust, TradePro.

MOTOR CROSS REFERENCE GUIDE

HP	TRADEPRO	WAGNER	EMERSON	AOS	FASCO	GE	MAGNETEK	MARATHON	DAYTON
1/3	TP-C33-1SP2HT-8	WG840205HT	1875H	FE1038SF	-	3205HS	-	-	AMB19
1/4	TP-C25-1SP2HT-8	WG840204HT	1874H	FE1028SF	-	3204HS	-	-	-
1/4	TP-C25-1SP2HT	WG840728HT	1860H	FSE1026SF	-	3732HS	-	-	-
1/3	TP-C33-1SP2HT	WG840729HT	1861H	FSE1036SF	-	3733HS	-	-	-
1/2	TP-C50-1SP2HT	WG840730HT	1862H	FSE1056SF	-	3734HS	-	-	-
1/3 - 1/5	TP-C33-MHP2HT-8	-	1875H	ORM5488F	-	3459	-	-	-
1/3 - 1/6	TP-C33-MHP2HT	-	3323H	ORM5458F	-	3458H	-	-	-
1/2 - 1/5	TP-C50-MHP2HT	-	5465H	FE6002F	-	-	-	-	-
1/3 - 1/6	TP-C33-MHP2-MAX	-	3323	ORM5458	-	3458	-	-	-

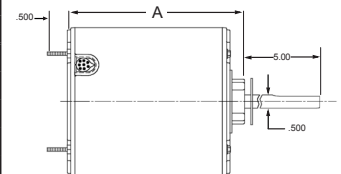

Fixed Fractional

VOLTS	SPEED	TRADEPRO	HP	AMP	BEARING	CAP	MOTOR LENGTH (A) DIM
208-230	825	TP-C25-1SP2HT-8	1/4	2.1	BALL	5µF / 370v	4.857"
208-230		TP-C33-1SP2HT-8	1/3	2.4	BALL	7.5µF / 440v	5.607"
208-230	1075	TP-C25-1SP2HT	1/4	1.5	BALL	5µF / 370v	5.107"
208-230		TP-C33-1SP2HT	1/3	1.8	BALL	7.5µF / 370v	5.607"
208-230		TP-C50-1SP2HT	1/2	3.3	BALL	10µF / 370v	5.857"

Multi-Horsepower

VOLTS	SPEED	TRADEPRO	HP	BEARING	CAP	MOTOR LENGTH (A) DIM	Full Load Amps					
							3/4 HP	1/2 HP	1/3 HP	1/4 HP	1/5 HP	1/6 HP
208-230	825	TP-C33-MHP2HT-8	1/3 - 1/5	BALL	7.5µF / 440v	5.607"	-	-	2.4	1.9	1.4	-
208-230	1075	TP-C33-MHP2HT	1/3-1/6	BALL	7.5µF / 370v	4.312"	-	-	2.0	1.7	1.4	1.2
208-230	1075	TP-C50-MHP2HT	1/2-1/5	BALL	15MF / 370V	6.357"	-	2.6	2.3	2	1.7	-
208-230	1075	TP-C33-MHP2-MAX	1/3 - 1/6	SAB	10µF / 370v	4.812"	-	-	2.5	2.3	1.8	1.3

*All marks shown are property of their respective owners